

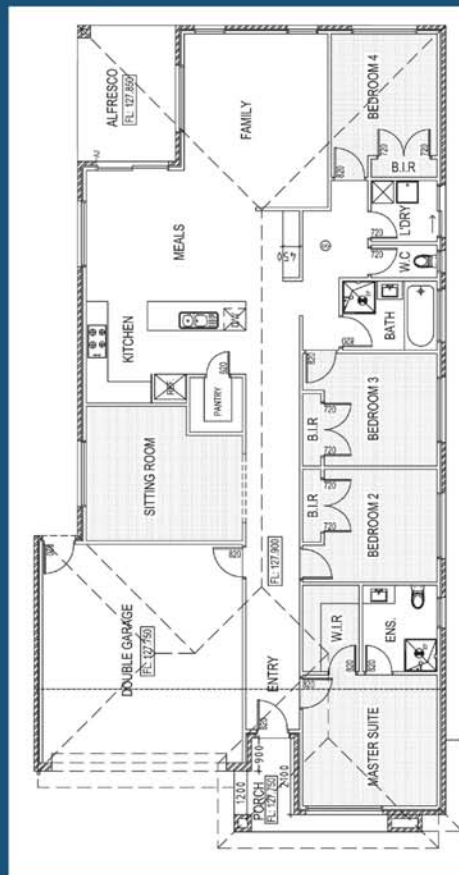

**Lot 2313 Riverwalk Estate Werribee
Liberty 24 (purewood)**

- Fixed Site Costs (P class)
- Front & rear landscaping
- Letter box and clothesline
- Side and rear fence
- Alarm system
- Ducted heating and evaporative cooling
- Floating flooring to kitchen/family
- Caesarstone benchtops throughout
- Gas cooker & Rangehood
- Stainless steel dishwasher
- Colorbond garage door with remotes
- LED Downlights throughout
- Window locks and Flyscreens to all openable windows
- Colored concrete to driveway and porch
- Blockout blinds throughout
- Ceiling height 2740mm throughout



Land: 480 sqm

Width: 16m

Length: 30m

House: 24sq 224sqm

4 Bed

2 Bath

2 Garage

House and Land

\$ 639,920

Land price \$345,000

*Disclaimer: This information has been carefully compiled and is not intended to be treated as a warranty or promise as to the correctness of the information. Interested parties should undertake independent enquiries and investigations to satisfy themselves that any details herein are true and correct. Figures and information may be subject to change without notice